

9462 Cooper-Atkins Floor Display

Assembly Instructions

1. Insert the joiners of the left and right uprights into the tube ends of the frame.

Be sure to meet the following criteria.

- * All sides with no holes face forward.

Left & Right Uprights:

- * Sides with two holes face the inside.

- * Sides with three holes face to the outside.

- * Sides with a hole near the bottom face back.

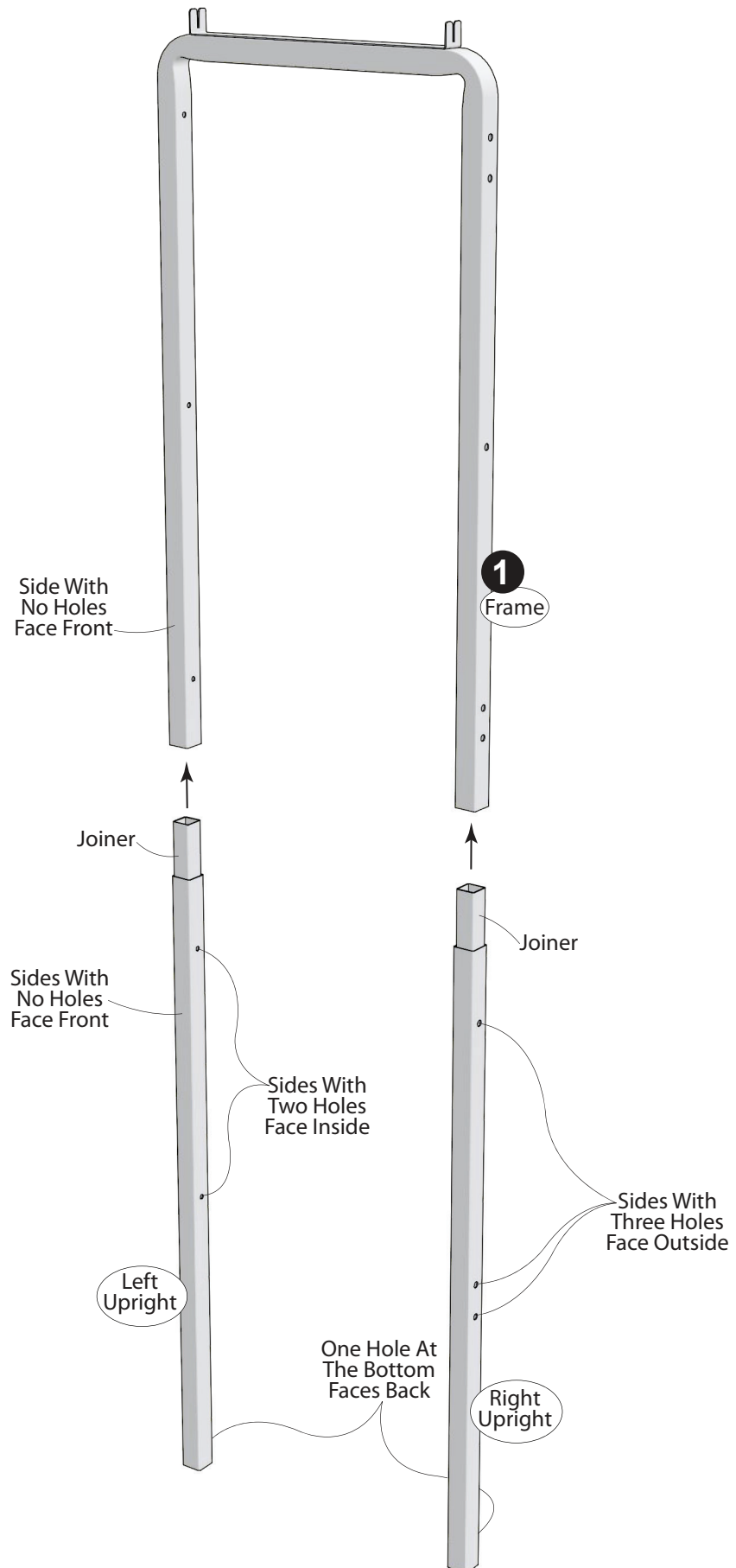

2. Place the grid panel into the frame assembly and use five bolts, washers and nuts per side to secure it. Make sure that the horizontal grid wires face front.

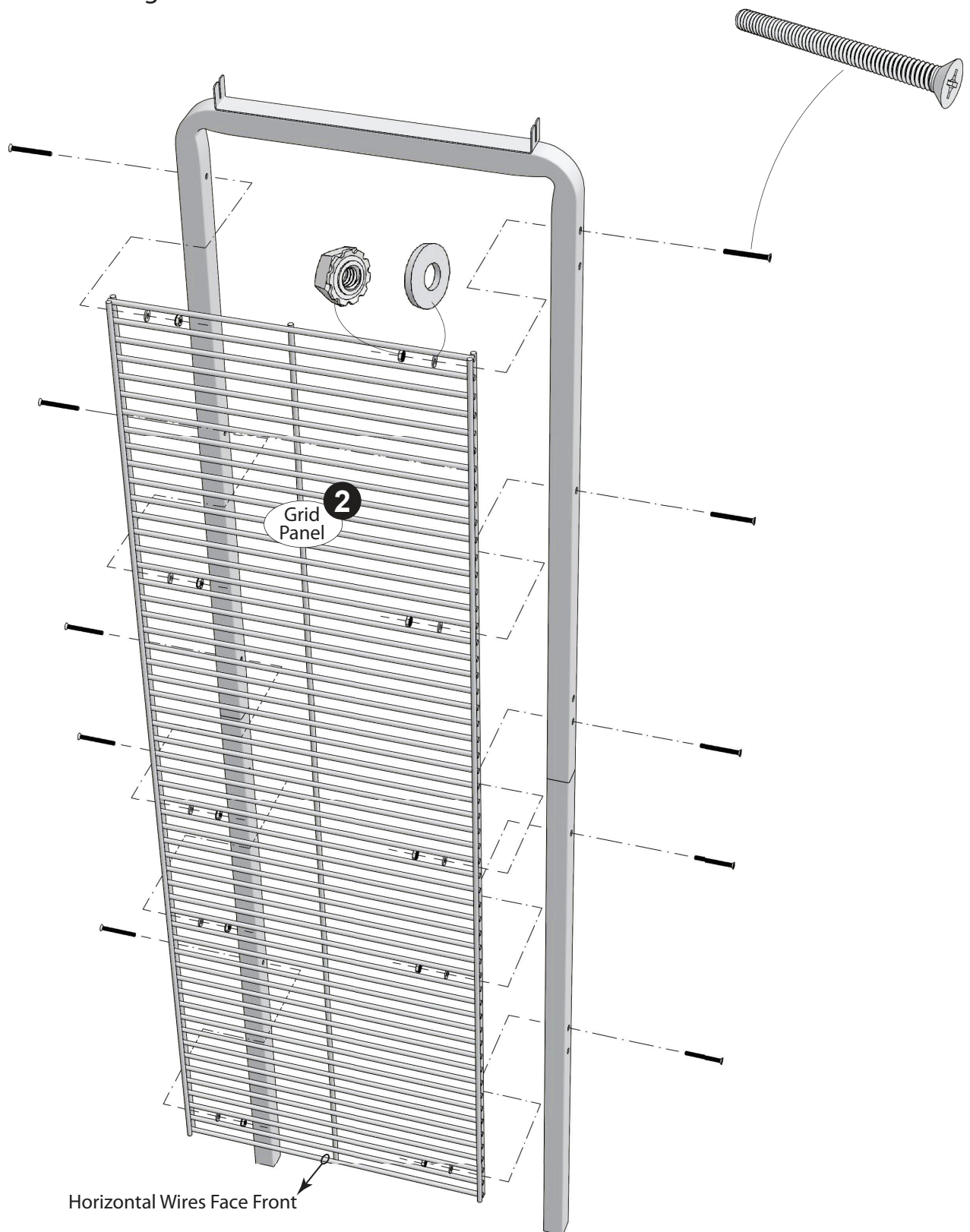

3. Place the tube ends of the frame assembly over the joiners of the base, then use two screws to secure.

4. Use six plastic push pins to mount the back panel to the back of the frame assembly. Be sure that the back panel 'artwork' faces the back of the display - 'away' from the grid panel.

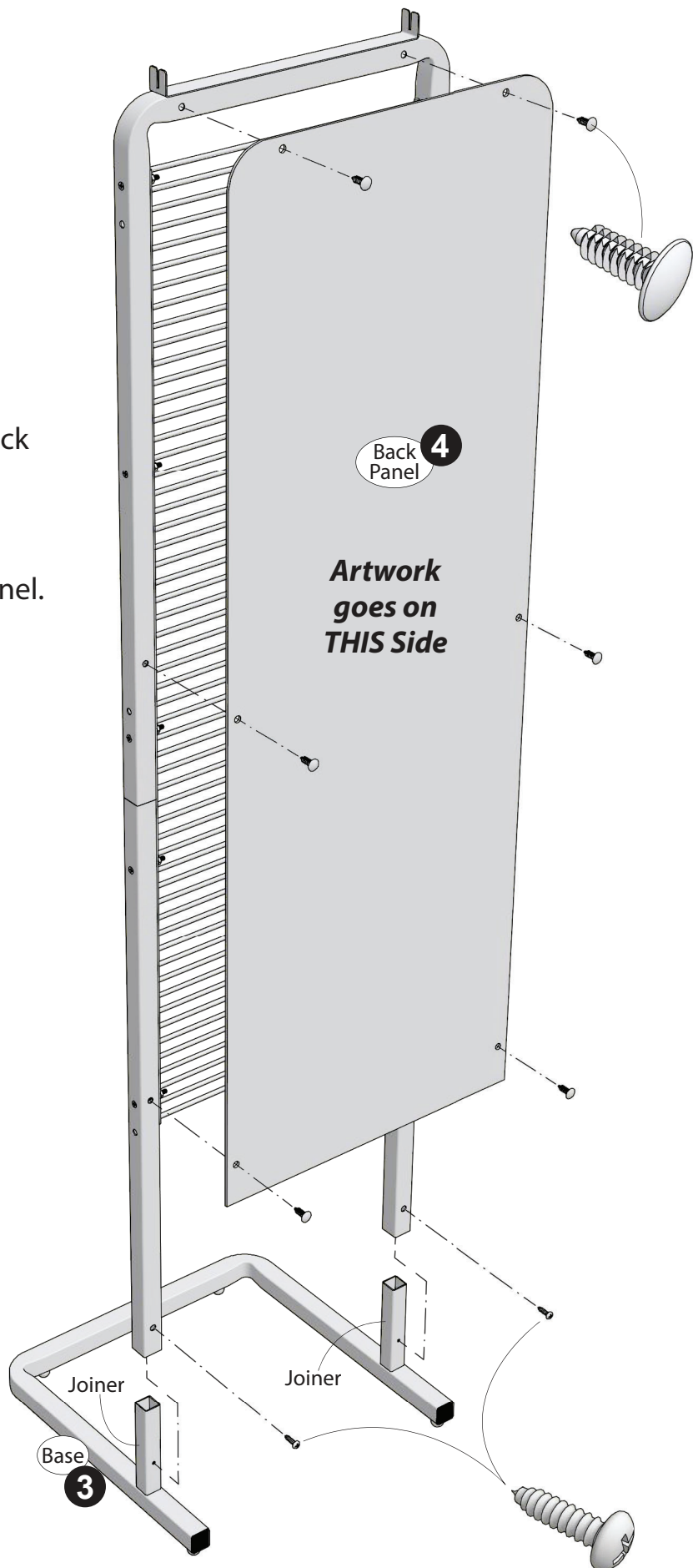

5. Use three plastic push pins each to mount the side panels to the frame assembly. Be sure that the side panel artwork faces outward.

Note: *The literature pocket can be mounted to either side of the display. It shares a plastic push pin with the side panel.*

6. Insert the bottom edge of the header into the two notches of the sign holder at the top of the display.

7. Place hooks onto the grid panel in positions that are best suited to products (not pictured).

