

Wireless Gateway Antenna Positioning

Technical Bulletin

For optimal performance, the Wireless Gateway (P/N 814-3550) antenna must be positioned perpendicular to the circuit board. Follow the instructions below to be sure the antenna is positioned correctly.

STEP 1: Remove the top of the enclosure from the base.

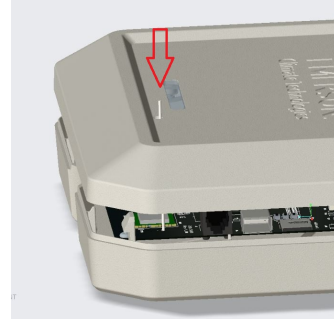

Figure 1 - Remove the Top of the Enclosure

STEP 2: Verify the antenna is positioned perpendicular to the circuit board.

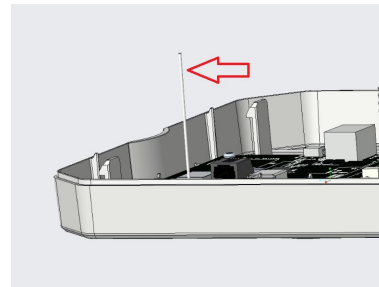

Figure 2 - Antenna Positioned Perpendicular

STEP 3: Guide the antenna through the pre-made hole in the top of the enclosure and reattach the top to the base. Verify the antenna is exposed through the hole and positioned perpendicular outside of the enclosure.

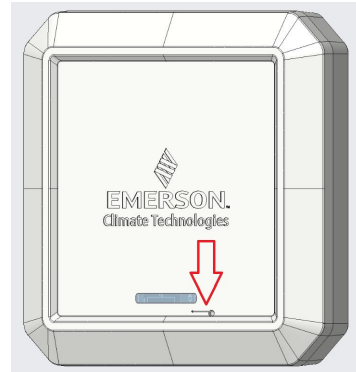

Figure 3 - Wireless Gateway Enclosure Front With Exposed Antenna

Document Part # 026-4848 Rev 0

Page 1 of 1

©2018 Emerson Climate Technologies Retail Solutions, Inc. This document may be photocopied for personal use. Visit our website at <http://www.emerson.com> for the latest technical documentation and updates.

Join Emerson Technical Support on Facebook <http://on.fb.me/WUQRnt>

For Technical Support call 770-425-2724 or email SolutionsTechSup@Emerson.com

The contents of this publication are presented for informational purposes only and they are not to be construed as warranties or guarantees, express or implied, regarding the products or services described herein or their use or applicability. Emerson Climate Technologies Retail Solutions, Inc. and/or its affiliates (collectively "Emerson"), reserves the right to modify the designs or specifications of such products at any time without notice. Emerson does not assume responsibility for the selection, use or maintenance of any product. Responsibility for proper selection, use and maintenance of any product remains solely with the purchaser and end-user. Emerson does not assume responsibility for the selection, use or maintenance of any product.

